

# ASSEMBLY INSTRUCTIONS

**MODEL : HD101A / HD102A**  
**QUEEN / FULL (4+4)**

## (Box 1)

BOX OF HEADBOARD & FOOTBOARD

No	ITEM	Qty
A	Headboard	1 pc
B	Footboard	1 pc
C	Headboard Leg (L)	1 pc
D	Headboard Leg (R)	1 pc
E	Footboard Leg (L)	1 pc
F	Footboard Leg (R)	1 pc
G	Bed Slats	4 pcs
H	Bed Slats Support	4 pcs

## (Box 2)

BOX OF SIDE RAIL

No	ITEM	Qty
I	Side Rail	2 pcs

## (Box 1)

HARDWARE LIST

No	ITEM	Qty
1	Csk M4 x 32mm	8 pcs
2	JCBC M6 x 35mm	12 pcs
3	JCBC M6 x 50mm	2 pcs
4	SpringWasher 1/4" Blk	14 pcs
5	Flat Washer 1/4"ID x 13mmOD Blk	12 pcs
6	Band Washer 15mm x 25mm Rbw	2 pc
7	Wood Dowel 8mm x 30mm	4 pcs
8	Allen Key m4 x 65mm Blk	1 pc
9	Allen Key m5 x 65mm Blk	1 pc
10	Unitar Screw m7 x 60mm	2 pcs

**STEP 1.1 : Attach Head Board Leg ( C ) & ( D ) to Head Board ( A ) . using JCBC BOLT ( 2 )with Spring Washer ( 4 ), Flat washer ( 5 ) and securing with ALLEN KEY ( 8 ) .**

**STEP 1.2 : Using Unitar Screw ( 10 )and securing with ALLEN KEY ( 8 ) as shown.**

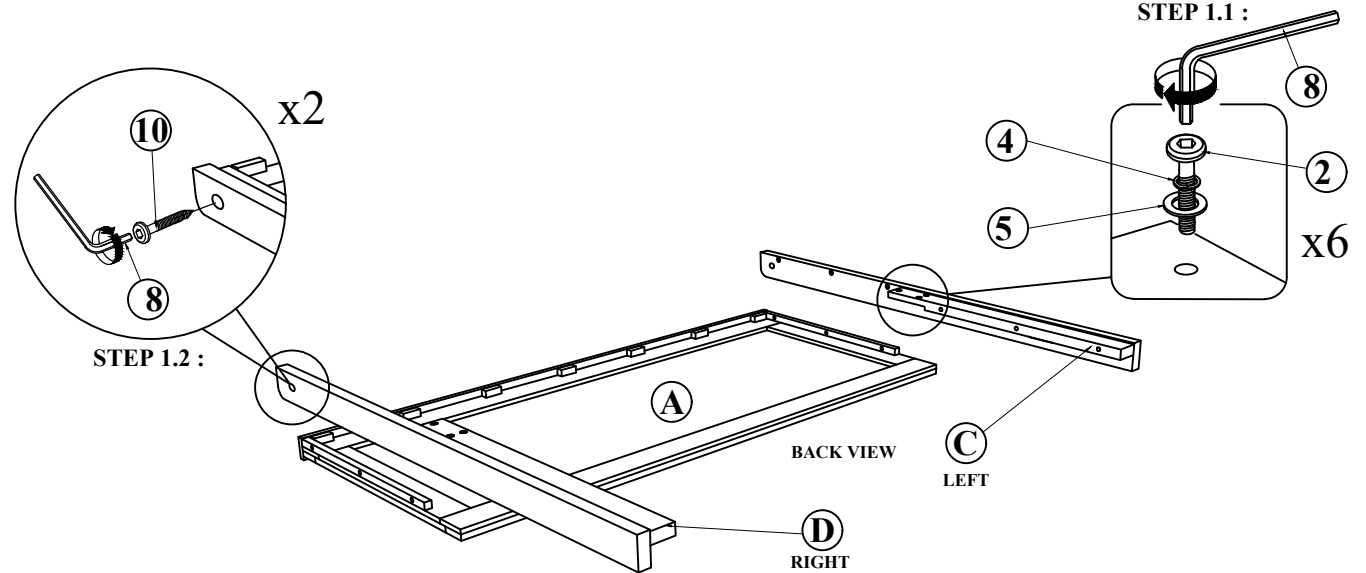

**STEP 2 : Using JCBC BOLT ( 2 )with Spring Washer ( 4 ), Flat washer ( 5 ) and securing with ALLEN KEY ( 8 ) as shown .**

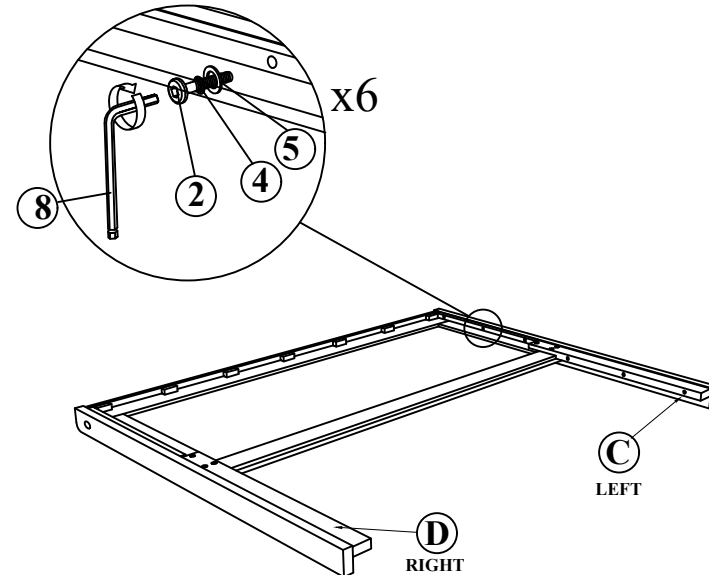

**NOTE : MUST TIGHTEN SCREWS PERIODCALLY WITH USE SCREW WILL BECOME LOOSE CHECK TIGHTNESS OF ALL SCREW EVERY 6-8 WEEKS.**

1 OF 2

# ASSEMBLY INSTRUCTIONS

**STEP 3 :** Attach Footboard Leg ( E ) & ( F ) to Footboard ( B ) as shown using Wood Dowel ( 7 ) and fix it as shown.

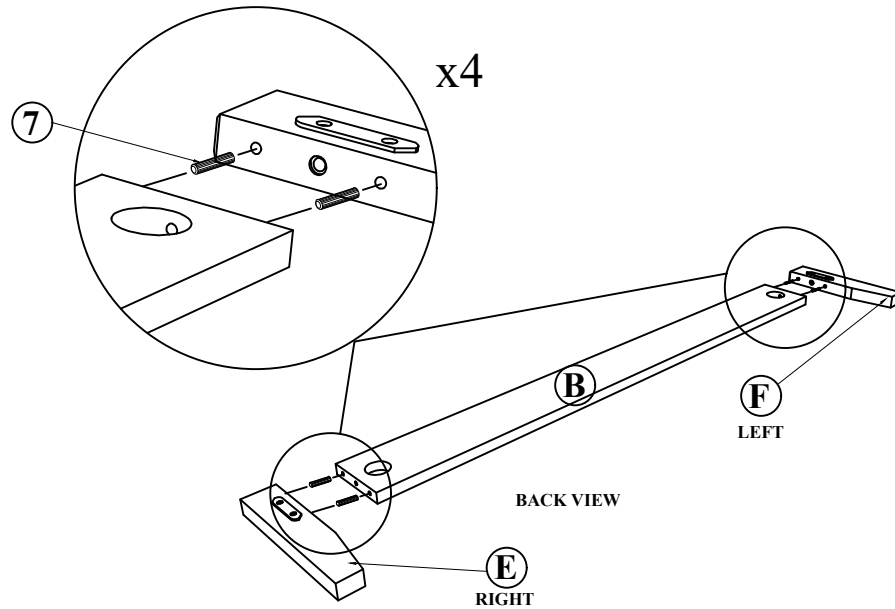

**STEP 4 :** Using JCBC BOLT(3) with Spring Washer (4), Band washer (6) and securing with ALLEN KEY ( 8 ) as shown .

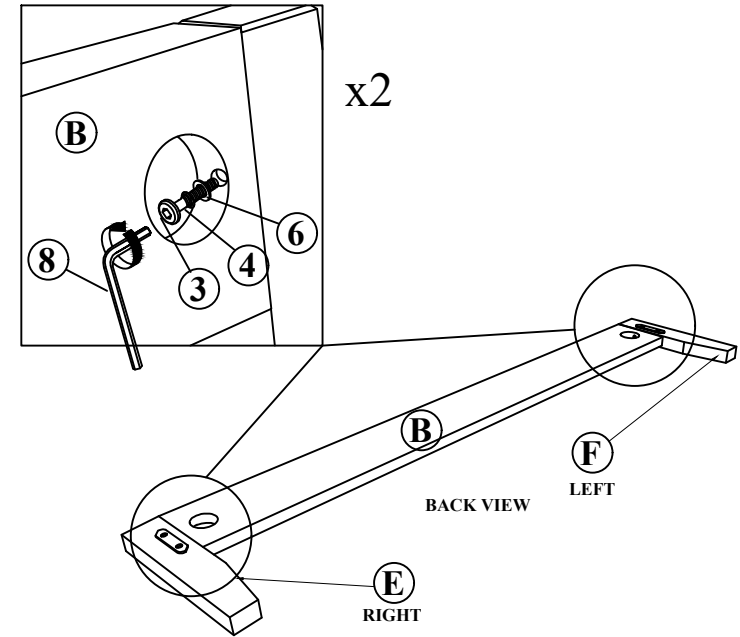

**STEP 5 :** Hook SIDE RAIL ( I ) TO HEAD BOARD ( A ) closely and push down to fit. repeat step 2 with other end of rail to hook onto FOOTBOARD ( B ).

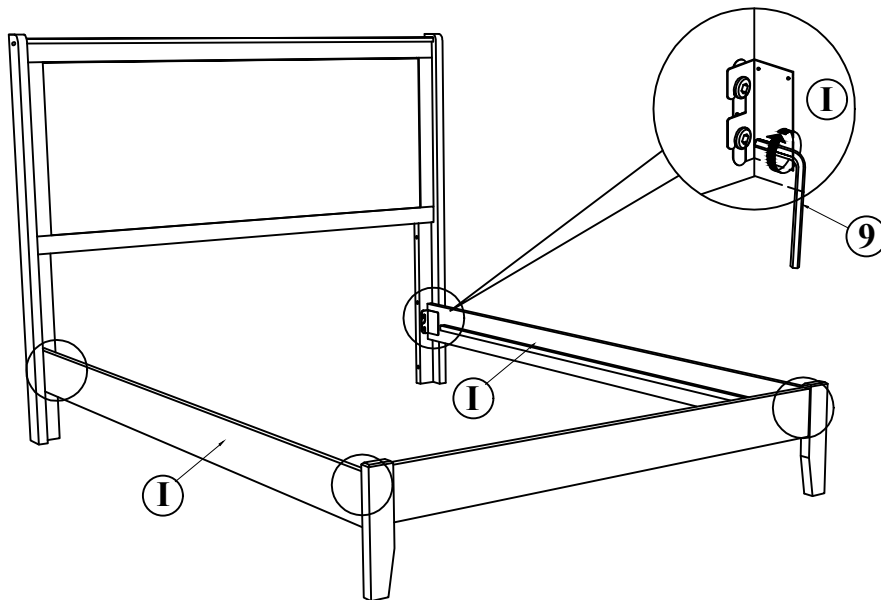

**STEP 6 :** Tighten the 4 Corner with Allen Key (9). Fix the Bed Slat Support Leg ( H ), to Bed Slat ( G ) as shown . Install the bed slat ( G ) to side rail ( I ) and tighten with Csk Screw ( 1 ) as per diagram shown. (NOTE: THE SETUP MUST DONE AT THE DECIDED LOCATION FOR THE BED TO OBTAIN PERFECT STABILITY)

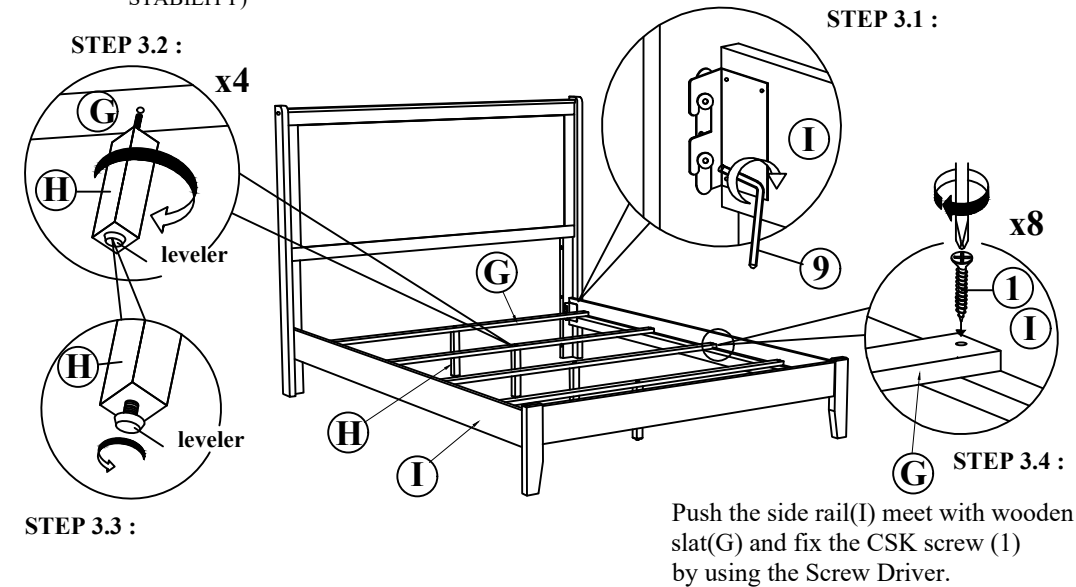

**NOTE :** MUST TIGHTEN SCREWS PERIODCALLY WITH USE SCREW WILL BECOME LOOSE CHECK TIGHTNESS OF ALL SCREW EVERY 6-8 WEEKS.

2 OF 2